

p:\active projects\25-035 stantec\new fire station no. 3\25-035 ver1\25-035 tb - stantec\_arch\_d\_vert

**1 ELECTRICAL SITE PLAN**  
3/32" = 1'-0"

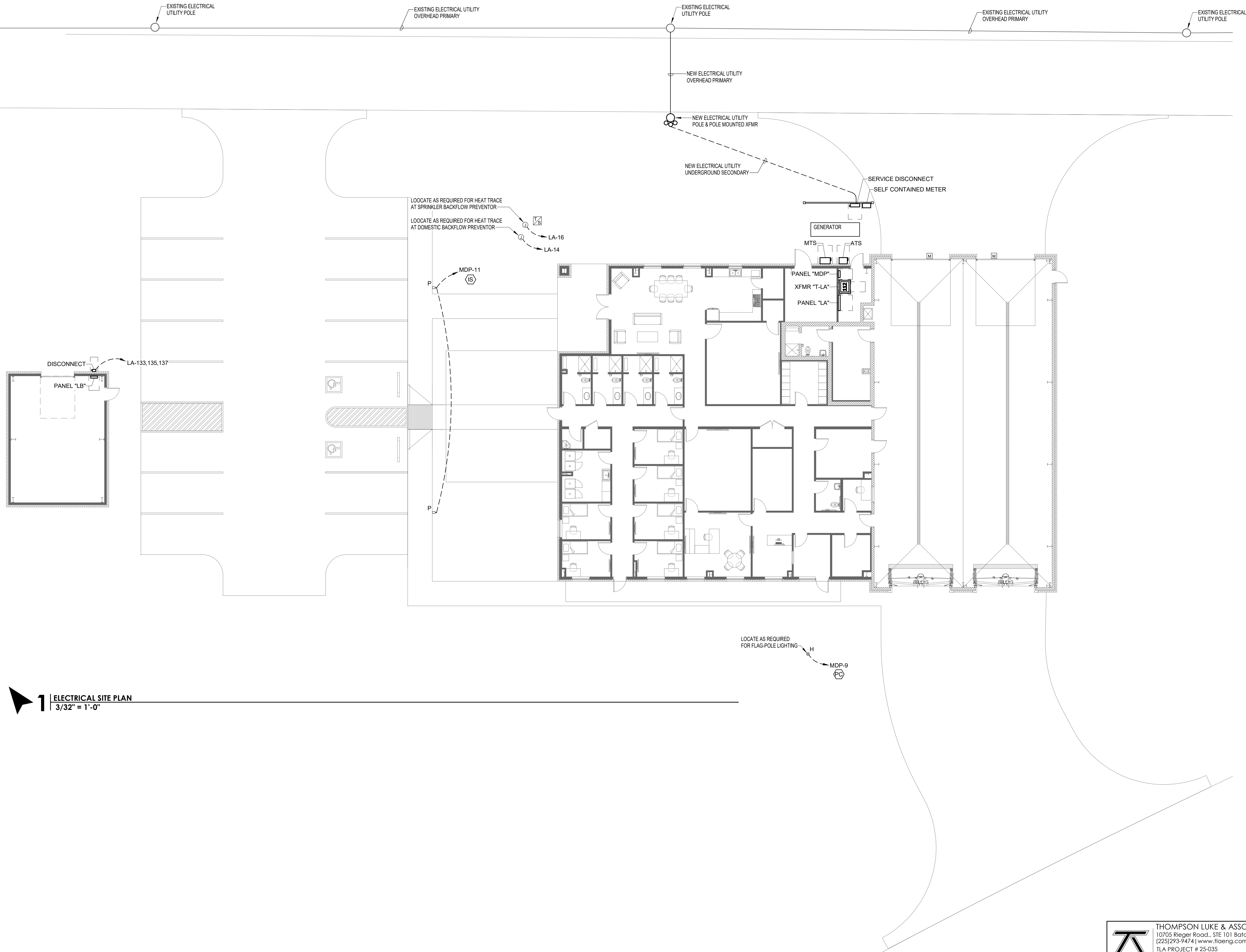

**THOMPSON LUKE & ASSOCIATES, L.L.C.**  
10705 Rieger Road., STE 101 Baton Rouge, LA 70809  
(225)293-9474 | www.tlaeng.com | office@tlaeng.com  
TLA PROJECT # 25-035  
Frank Saville Thompson - License No. 28854  
Landon David Burns - License No. 46484

**Stantec**  
Stantec (Formerly Bradley-Bentley & Associates)  
1200 Brickyard Lane, Suite 400  
Baton Rouge, LA 70802  
Tel: 225-765-7400  
www.stantec.com  
Copyright Reserved  
The Contractor shall verify and be responsible for all dimensions. DO NOT scale the drawing. The Contractor shall verify and be responsible for all dimensions. DO NOT scale the drawing. The Contractor shall verify and be responsible for all dimensions. DO NOT scale the drawing.

Revision	By	Appd
		YYYYMMDD

Design Phase Acceptance

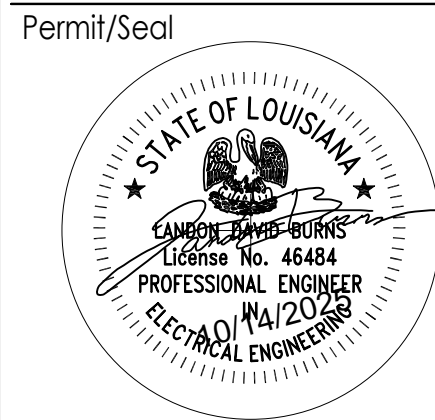

Client/Project  
**CITY OF NATCHITOCHES**  
**NEW FIRE STATION NO. 3**  
NATCHITOCHES, LOUISIANA

Project No.: 222706059  
File Name: 25-035 TB - STANTEC\_ARCH\_D\_VERT  
Scale:  
Dwn. Dgn. Chkd. 2025.09.26  
YYYY-MM-DD  
Title  
**ELECTRICAL SITE PLAN**

Revision: Sheet: of  
Drawing No. **E200**